

Description: Single axis potentiometric joystick. Available in many different configurations, including spring return to center, spring return to end, and friction lock. Other options include switches at end of travel and center detent (lock). Any of our L, M, S, P, or B series grips can be mounted on this joystick.

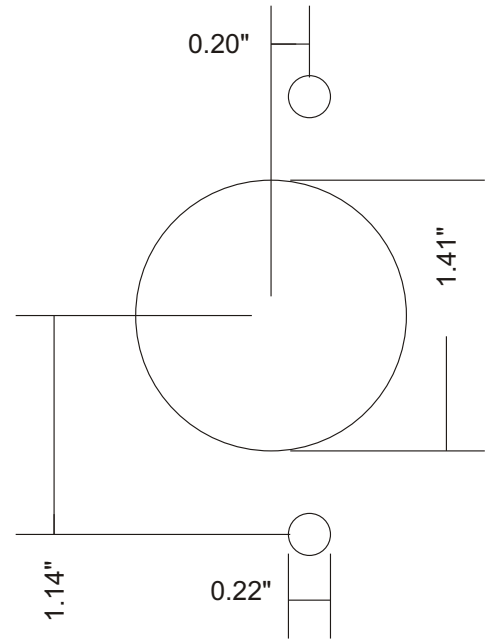
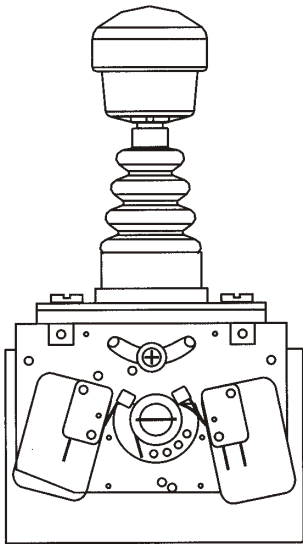

Panel Mounting Dimensions

Mechanical:	Min.	Typ.	Max	Units	Comments
Height		100		mm	Above Panel
Length		50		mm	
Width		95		mm	
Mechanical Angle		+/-37		Degrees	
Operating Life		>1		Million	Cycles
Electrical:	Min.	Typ.	Max	Units	Comments
Potentiometer					
Resistance	9000	10000	11000	Ohms	
Power Rating		0.25		Watts	
Center Tap Voltage	0.48	0.5	0.54		Of supply voltage
Environmental:	Min.	Typ.	Max	Units	Comments
Operating Temp.	-25		70	°C	
IP Rating		IP65			Above Panel

#10 953 Laval Cr. Kamloops BC V2C 5P4
 800 Fifth Ave. #101-507 Seattle WA 98104
 Ph. (877) 377-1117 Fax (877) 377-4036
www.controlgrips.com